



GENERAL KNIGHT ON THE FRONT LINES



A CONTAINER SHIP NEAR THE PORT OF TRANQUILITY



EMPEROR BLUE EYES' CABIN ON THE FRONT LINES



REMUS LUPIN IN BINGO (PICTURE SHOT IN 1957)

# THE FELINE TIMES



## Wu-Wu-Wu Zap Busts Through Wall

Wu-Wu-Wu Zap, famous criminal villain, has busted through Fortress Moonbeam's wall in order to do an evil rampage. The medics on the front lines have been trying to keep up with the flood of patients coming in to them. Wu-Wu-Wu Zap is currently trying to force entry into the fortress, but no one knows if he can be repelled from Fortress Moonbeam.

The weather will be rainy up until Wednesday. 🌧️

[ETHWeather.com](http://ETHWeather.com)

# Dollhouse Leaves Dining Room Tomorrow

The ETH Dollhouse, flagship of Ethanland, will tomorrow leave Mother Coast and set sail for Bingo. The ticket costs the same as yesterday's newspaper said, except you need special permission to go to Secret Island. Today, though, the dollhouse is loading up on supplies, and its passengers are trying to relax and enjoy the beaches of Mother Coast.

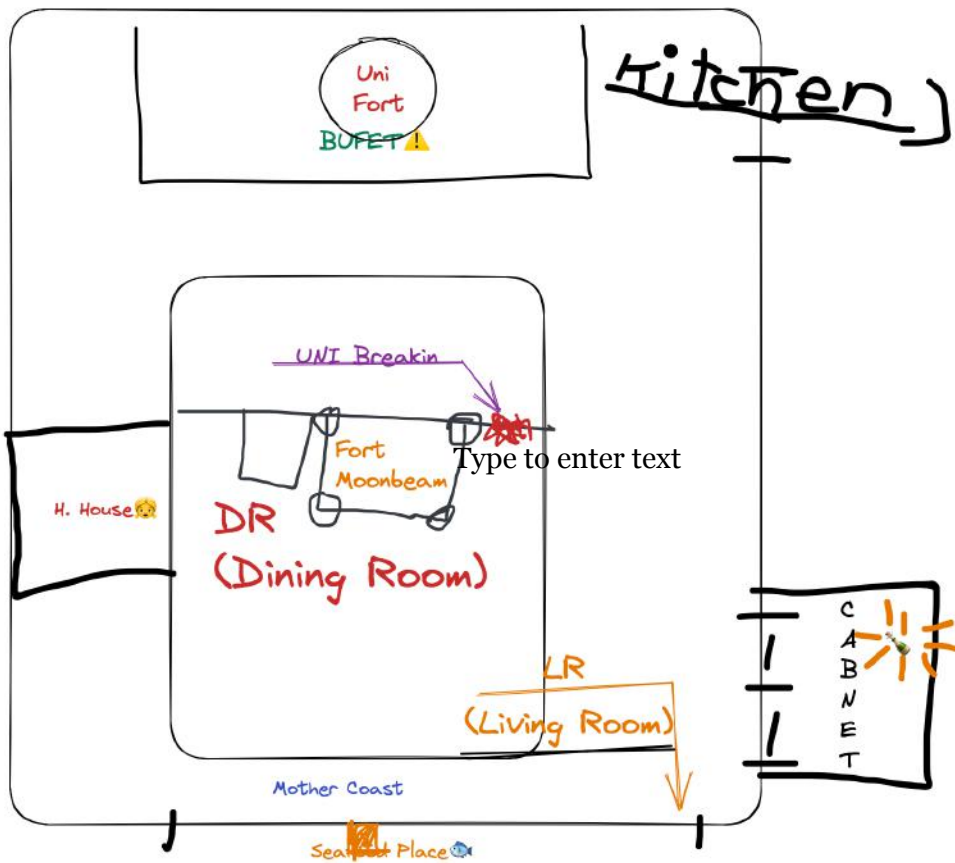

### Menu:

Steak	\$20
Tea	\$10
Chicken Noodle Soup	\$20
Soft Drink	\$11
Bread	\$5
Toast	\$5
Eggs	\$8
Carrots	\$6
Green Peppers	\$5

